

# UPster® K

Rack type dishwashing machines

**NEW**  
**UPSTER K**

Even more efficient\*,  
with the same great  
cleaning performance  
and hygiene



INTERNATIONAL

\*All data compared to the previous model.  
Measured using the UPster® K-M 280







The *UPster*® range ups efficiency in the dishwashing area even further. As *UPster*® rack type dishwashing machines provide professional warewashing technology – precisely calculated and delivered in just a few working days. They have the potential to create savings thanks to the developments in the washing system. Save money while dishwashing? Yes! For new entrants and smart professionals.

### **Versatile and easy to combine**

The dishwashing area is often a squeeze and tensions can run high. Our rack type dishwashing machines of the *UPster*® K range are designed for that environment: They are compact, easy to operate and great value for money, making them the ideal choice for dishwashing areas that need a rack solution and efficient washing performance. Removing the need for an exhaust air connection improves indoor climate and contributes to a comfortable environment.



# UPster® K-S 160

Packs plenty of power – for up to 160 racks/h

Despite its small dimensions, the  
UPster® K-S 160 really packs a punch.  
Tiny but mighty.



**NEW  
UPSTER K**  
Uses up to  
**38% less water**  
and up to  
**21% less energy**  
than the  
previous model\*

Sectional view of the UPster® K-S 160

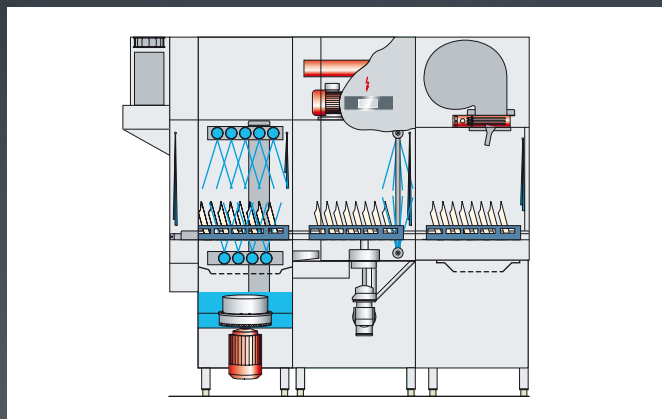

**Passing height**

508 mm

**Rack capacity (programme 1 - 2 - 3)**

80 - 120 - 160 racks/h

**Rinse water volume** (in continuous operation)

160 litres/h

**Total connected load**

24.7 kW incl. heat recovery and drying

**Power consumption<sup>1</sup>**

16.6 kW incl. heat recovery and drying

**Machine length**

1,300 mm excl. drying / 1,900 mm incl. drying

<sup>1</sup> This is an average value (for the warewashing process) based on a sample plate setting and operating mode. Data for specific installations should be derived from economic calculations for each specific project.

Electrical power supply pipe to the machine 3/N/PE, 400 V, 50 Hz. Main switch must be provided by customer on site.

# UPster® K-S 200

Great performance – for up to 200 racks/h

An additional final rinse zone keeps everything running smoothly, increasing rack capacity per hour: *UPster® K-S 200*.



**NEW  
UPSTER K**  
Uses up to  
**38% less water**  
and up to  
**21% less energy**  
than the  
previous model\*

Sectional view of the *UPster® K-S 200*

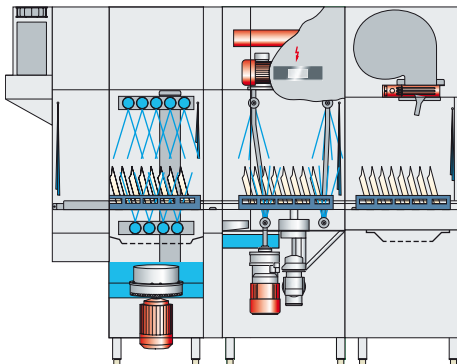

**Passing height**

508 mm

**Rack capacity (programme 1 - 2 - 3)**

95 - 150 - 200 racks/h

**Rinse water volume** (in continuous operation)

160 litres/h

**Total connected load**

25.2 kW incl. heat recovery and drying

**Power consumption<sup>1</sup>**

17.0 kW incl. heat recovery and drying

**Machine length**

1,550 mm excl. drying / 2,150 mm incl. drying

<sup>1</sup> This is an average value (for the warewashing process) based on a sample plate setting and operating mode.

Data for specific installations should be derived from economic calculations for each specific project.

Electrical power supply pipe to the machine 3/N/PE, 400 V, 50 Hz. Main switch must be provided by customer on site.

# UPster® K-M 250

Gets the job done – for up to 250 racks/h

Quick and clean: the UPster® K-M 250 features a pre-wash zone. It effortlessly cleans up to 190 racks per hour. Incredible!



**NEW  
UPSTER K**  
Uses up to  
**38% less water**  
and up to  
**21% less energy**  
than the  
previous model\*

Sectional view of the UPster® K-M 250

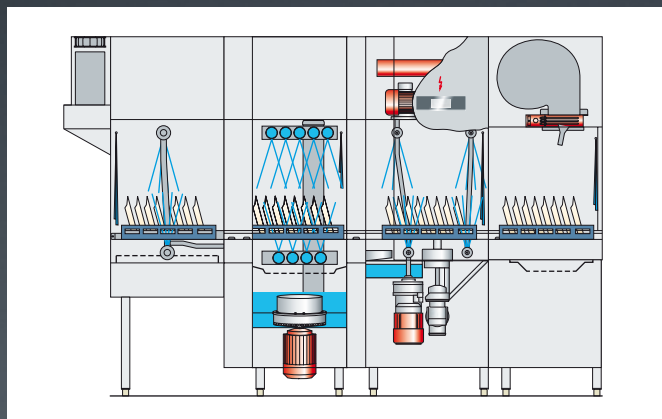

## Passing height

508 mm

## Rack capacity (programme 1 - 2 - 3)

125 - 190 - 250 racks/h

## Rinse water volume (in continuous operation)

160 litres/h

## Total connected load

25.2 kW incl. heat recovery and drying

## Power consumption<sup>1</sup>

17.0 kW incl. heat recovery and drying

## Machine length

2,050 mm excl. drying / 2,650 mm incl. drying

<sup>1</sup> This is an average value (for the warewashing process) based on a sample plate setting and operating mode. Data for specific installations should be derived from economic calculations for each specific project. Electrical power supply pipe to the machine 3/N/PE, 400 V, 50 Hz. Main switch must be provided by customer on site.



# UPster® K-M 280

Maximum power – for up to 280 racks/h

210 racks/h – the additional wash tank on the *UPster® K-M 280* increases its wash capacity and provides maximum power and performance with optimum use of space.



Sectional view of the *UPster® K-M 280*

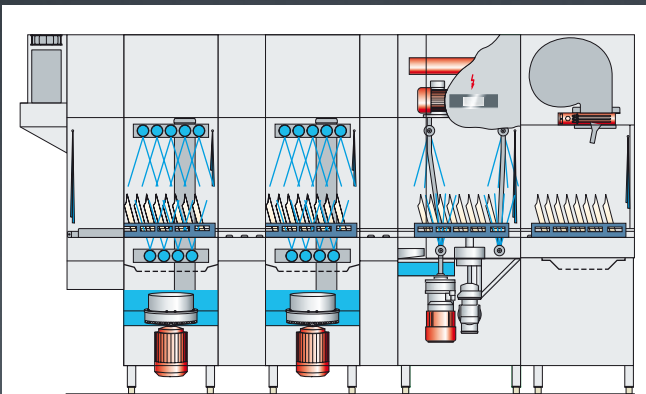

#### Passing height

508 mm

#### Rack capacity (programme 1 - 2 - 3)

140 - 210 - 280 racks/h

#### Rinse water volume (in continuous operation)

160 litres/h

#### Total connected load

26.9 kW incl. heat recovery and drying

#### Power consumption<sup>1</sup>

18.1 kW incl. heat recovery and drying

#### Machine length

2,350 mm excl. drying / 2,950 mm incl. drying

<sup>1</sup> This is an average value (for the warewashing process) based on a sample plate setting and operating mode. Data for specific installations should be derived from economic calculations for each specific project.  
Electrical power supply pipe to the machine 3/N/PE, 400 V, 50 Hz. Main switch must be provided by customer on site.

# UPster® K-L 340

Twice the cleaning capabilities for up to 340 racks/h

The UPster® K-L 340 doubles up on everything. As well as an additional pre-wash zone, it also features a complete second wash system for maximum power and cleanliness, boosting rack capacity as high as 250 racks an hour. This machine takes cleaning to the max!

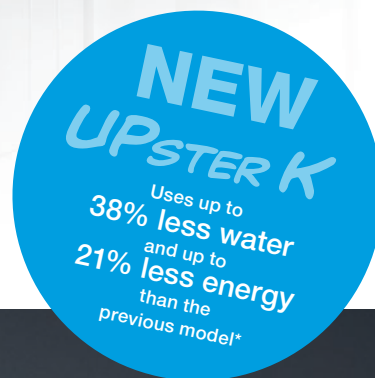

Sectional view of the UPster® K-L 340

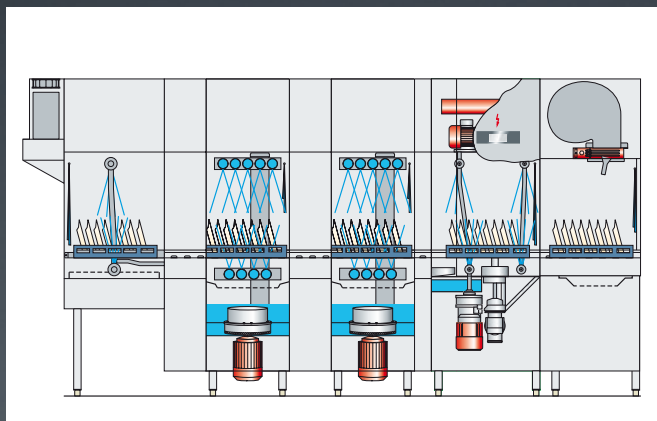

#### Passing height

508 mm

#### Rack capacity (programme 1 - 2 - 3)

170 - 260 - 340 racks/h

#### Rinse water volume (in continuous operation)

160 litres/h

#### Total connected load

33.4 kW incl. heat recovery and drying

#### Power consumption<sup>1</sup>

22.5 kW incl. heat recovery and drying

#### Machine length

2,850 mm excl. drying / 3,450 mm incl. drying

<sup>1</sup> This is an average value (for the warewashing process) based on a sample plate setting and operating mode. Data for specific installations should be derived from economic calculations for each specific project. Electrical power supply pipe to the machine 3/4" PE, 400 V, 50 Hz. Main switch must be provided by customer on site.



The *UPster® K* offers sophisticated technology in a user-friendly MEIKO package, setting new standards in cleanliness, speed and user safety.

Highlights include easy-clean technology, user-friendly operation thanks to the blue operating concept, an energy-saving machine design which eliminates the need for an air extraction system, and ergonomic operation using a clearly formatted glass operating panel.

Clarity is the number one priority. The high-contrast illuminated glass operating panel keeps the operator fully informed at every stage of the warewashing process. It only displays the functions which are currently available for use or currently in progress. All the key information is available at a glance, and a constant dialogue is maintained between the machine and its human operators.



One-touch operation makes it easy for the operator to navigate through the programme options.

**UPster® K**

Breathe: improved indoor climate with no exhaust air connection





Overheating, too much steam? The dishwashing area doesn't have to be like this.

The *UPster® K* uses an integrated heat recovery system and minimises uses of valuable resources, saving up to 38%\* on water and up to 21%\* on energy consumption. And, as a bonus, the climate in the dishwashing area becomes lovely and pleasant.

*UPster® K* machines do not require any additional exhaust vent, so that saves you the cost of fitting a standard separate exhaust air connection.\*\*

**Our assessment: decidedly positive in both eco credentials and economic calculations.**

***UPster® K*: a clever creation for shrewd spenders.**



\*All data compared to the previous model.  
Measured using the *UPster® K-M 280*

\*\*Assuming adequate room ventilation in line with VDI 2052 regulations.



## MEIKO Connect

The smart cockpit of your dishwashing machine

*MEIKO Connect* makes it easier to monitor professional kitchens. Simply use your smart-phone to monitor all the essential machine and hygiene data for your MEIKO dishwashing machine – it couldn't be easier!

Scan the QR code to get started



## CC Insight

Stay even better informed

The *UPster® K* also offers users the option to browse comprehensive data online (*CC-Insight*), on a smartphone, or through the CC data module.

All system-relevant data, functions and operating processes are stored and displayed by the built-in gateway. Operating conditions are analysed and diagnosed, and can easily be changed on the computer where necessary.



### Alternative to the MEIKO Connect app

The CC-Log data module offers a convenient way to transfer operating data via Bluetooth.

**UPster® K**

508 mm – plenty of room!

**m**  
**MEIKO**  
The clean solution

Tall trays and big pots – some washware is bulky and difficult to manage. But the MEIKO *UPster® K* takes everything in its stride. With a maximum passing height of 508 mm,

*UPster®* machines set a new standard in their class. They can comfortably accommodate bulky items and get them sparkling clean. Sounds like the perfect solution!



## Blue is the colour of user-friendly operation

MEIKO uses a striking blue to mark all the components and parts of its machines which users can interact with – an intuitive approach which everyone can follow. No words needed, and no lengthy operating instructions either! This is MEIKO's way of making communication between machines and humans as easy and efficient as possible. It's teamwork at its best – and the most enjoyable way of achieving professional results.



## A fantastic choice in any size

Thanks to their modular design, *UPster® K* machines can be nice and compact or big and bold. But whatever size they are, they always make the best use of the available space.

The *UPster® K* will fit beautifully into your kitchen layout but still costs less than a made-to-measure machine.

*UPster® K-S 160*

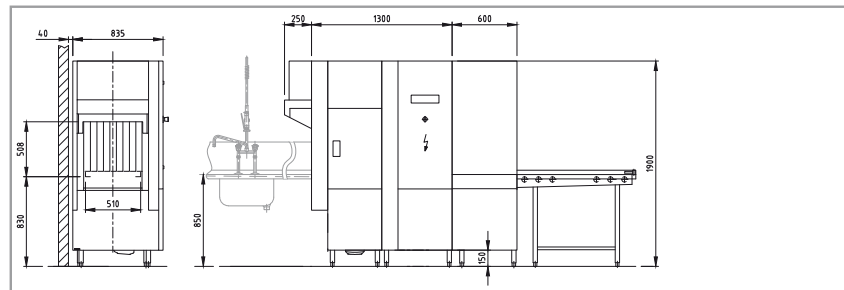

*UPster® K-S 200*

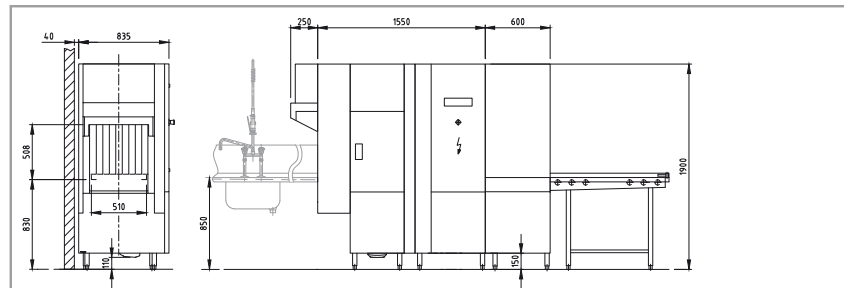

*UPster® K-M 250*

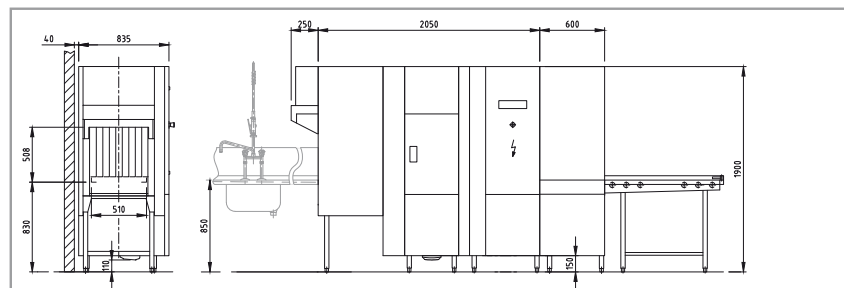

*UPster® K-M 280*

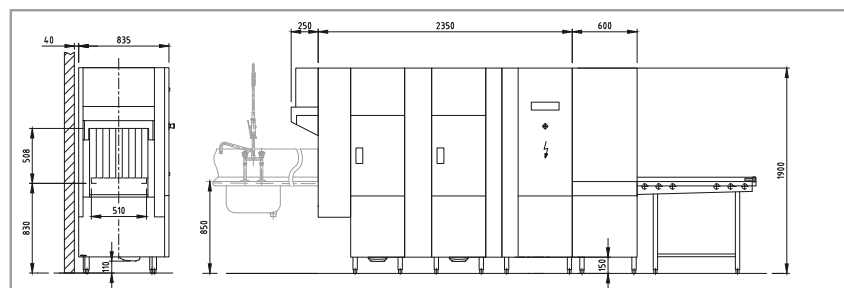

*UPster® K-L 340*

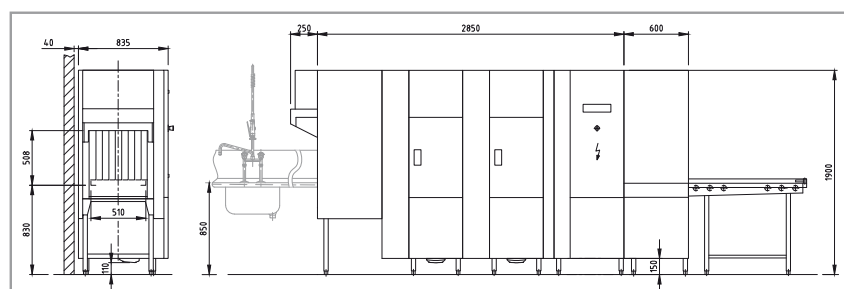



Whatever kind of washware your business uses, *MEIKO ACTIVE* can offer a solution that is perfectly tailored to your needs. Every aspect of professional cleaning agents is taken into account – from hygiene safety to environmental compatibility.

The *MEIKO ACTIVE* range is largely free from chlorine and phosphates and it does not use EDTA or NTA at all. The planet will thank us. Instead, we use powerful active ingredients that are more eco-friendly while still ensuring sparkling results. The perfect solution!



## For all common applications and water hardness levels

With so many different types of ware to wash, you need cleaning agents that are specially designed to get the job done.

That's why the *MEIKO ACTIVE* range includes detergents and rinse aids for all the most common applications, all types of washware, all degrees of soiling and all water conditions.

We ensure you get a combination of detergent and rinse aid that is perfectly tailored to your needs, your warewashing technology and your on-site requirements. We always aim to find an eco-friendly solution that minimises resource use and operating costs.

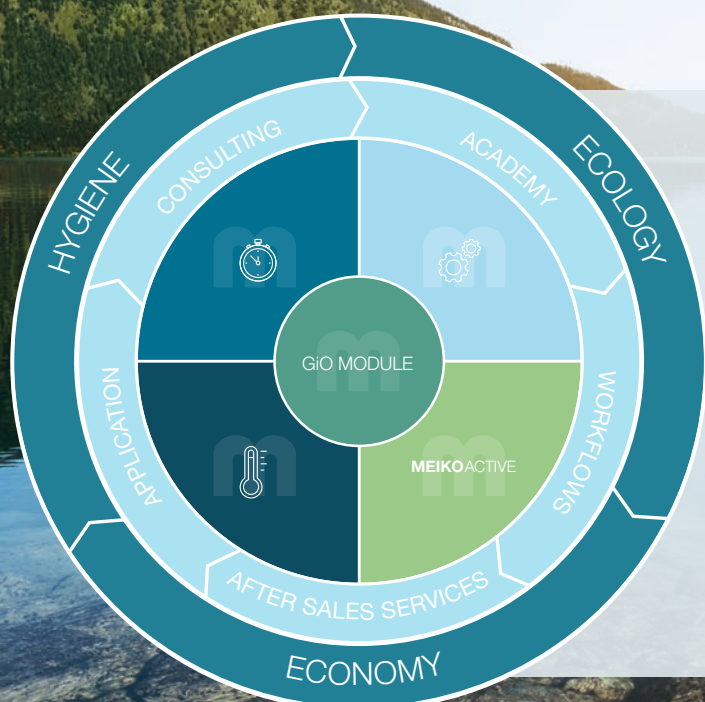

## All in one

Welcome to the *MEIKO Clean Solution*, a world of elements and services that cover the entire warewashing process – the full service – from A to Z.

The *MEIKO Clean Solution Circle* encompasses all the parameters relevant to a cleaning process, including their interrelationships and dependencies.

At its core is 'Sinner's circle' of time, temperature, mechanical action and chemicals – the four factors that chemist Herbert Sinner identified as the key to cleaning performance. Yet this wouldn't be complete without the right choice of applications, services, consulting and workflows – plus training from the *MEIKO Academy*. Taken together, this addresses the key concerns of hygiene, economy and ecology.

Mix and match to get the best out of the technology available: a simple dishwashing system with straight, flat tables or 90° and 180° curves with drive using roller conveyors. Perhaps a cleverly designed sink centre? It's all possible with

the *UPster® K*. We would be delighted to advise you further as to what versions would best fit with your ergonomic and business needs.

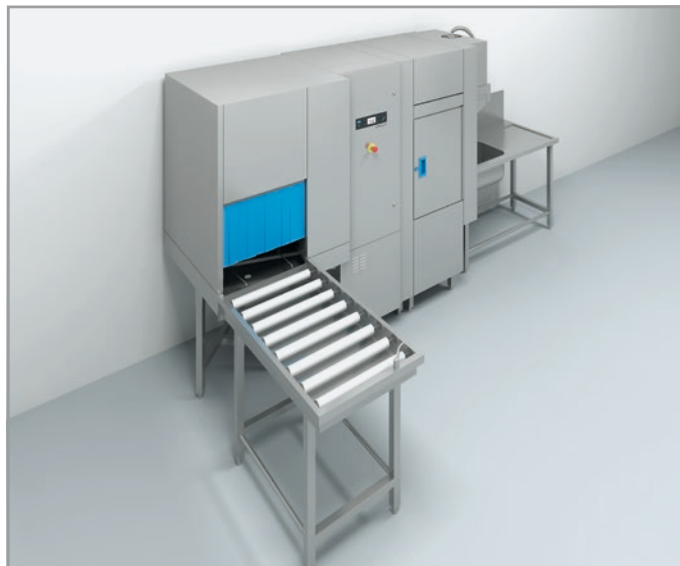
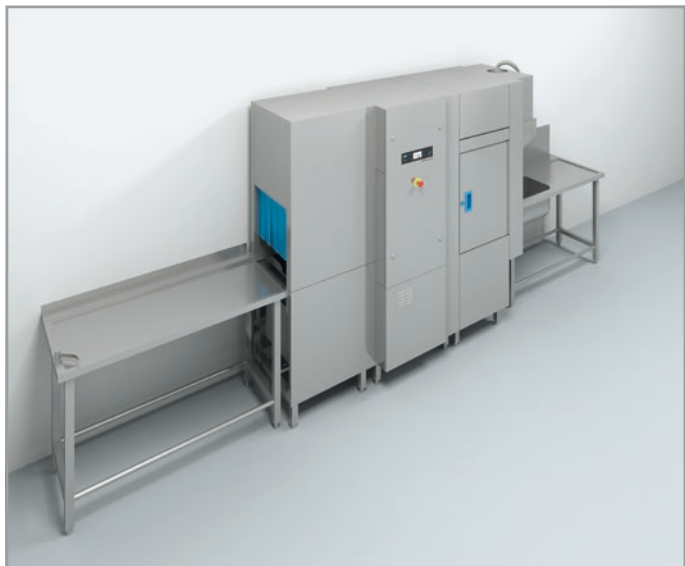

The machine fulfils the hygiene requirements specified in EN 17735.



For sustainable hygiene and impressive washing results, MEIKO recommends cleaning and hygiene products made by **MEIKO ACTIVE**.