

Bottle rack

Operating instructions

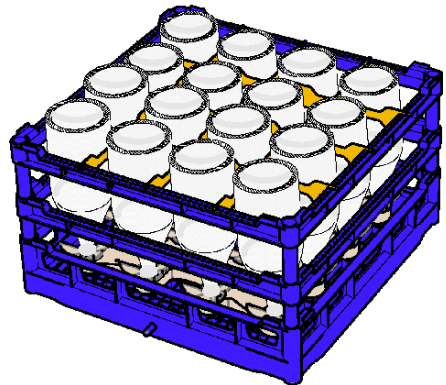

DE:

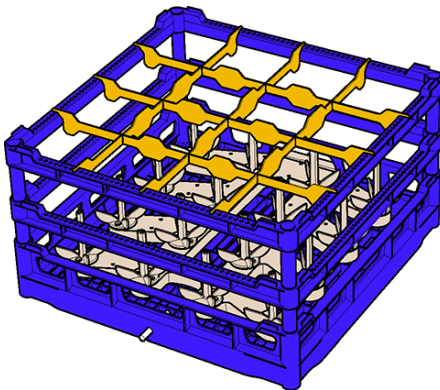

EN:



EN



Read the operating instructions before using the bottle rack!

Translation of the "original operating instructions"

Contents

1	NOTES ON THE OPERATING INSTRUCTIONS	3
1.1	Product identification	3
1.2	Delivery contents	3
1.3	Related documents	3
1.4	Presentation conventions	3
1.4.1	<i>Safety symbols in the instructions</i>	4
2	SAFETY	4
2.1	Intended use	4
2.2	Misuse	5
2.3	Safety information	5
2.4	Requirements for the personnel	5
3	PRODUCT DESCRIPTION	6
3.1	Bottle properties	7
3.2	Bottle programme	8
4	OPERATION/USE	9
5	CLEANING	10
6	INDEX	11

1 Notes on the operating instructions

Before using the bottle rack, read the operating instructions and the related documents carefully and keep them in a safe place and within easy reach.

These operating instructions can be downloaded via the following address: www.meiko.info or <https://partnernet.meiko-global.com>.

1.1 Product identification

These operating instructions apply to the bottle rack compatible with MEIKO dishwashing machines M-iClean U (U type M2) and ET 8.1 (ET 8.1 type M2).

1.2 Delivery contents

The delivery contents include:

- 1x bottle rack, 1x adapter
- Documentation, for details see **Related documents**

1.3 Related documents

In addition to these operating instructions, there are other documents:

- Operating instructions for M-iClean U (U type M2) / ET 8.1 (8.1 type M2)
- Short operating instructions (in the scope of delivery)

1.4 Presentation conventions

Warnings

 **DANGER** – indicates an imminently hazardous situation which, if not avoided, will result in serious injury or death.

 **WARNING** – indicates a potentially hazardous situation which, if not avoided, could result in serious injury or death.

 **CAUTION** – indicates a possible hazardous situation which, if not avoided, could result in minor or moderate injury or damage to property.

Notices on use



Note – indicates useful and important information about the product or its use.

Notes on using the document:

- A bullet point (•) designates an action step.
- Numerals (1.) designate several action steps that must be executed in the specified sequence.
- Position numbers in the text that refer to position numbers in illustrations are shown in parentheses:
(1) Position number 1 in the illustration
- The text is always below the illustration and refers to it until a new image follows.

1.4.1 Safety symbols in the instructions



Read the operating instructions

2 Safety

2.1 Intended use

The bottle rack is intended exclusively for commercial use and is used to wash bottles in hotels, food service and communal catering. Suitable bottle types, see page 7. The maximum or minimum bottle heights and diameters must not be exceeded or fallen short of. The cover grid 1000134 from the MEIKO rack range can be used for bottles or containers lighter than 30 g.

The bottle rack is only suitable for M-iClean UM/UM+, UM M2 type and UM+ M2 type dishwashing machines. For any use of the bottle rack for cleaning bottles, the supplied adapter must be inserted and locked in place of the lower rotating arm of the dishwashing machine, see page 8. The bottle rack may only be used with the wash programmes approved for the bottle rack (see page 9).

2.2 Misuse

- Washing of bottles that are not suitable for cleaning in the bottle rack, see page 7.
- Use of an unsuitable wash programme with too short a runtime, too low temperatures and too little rinse water volume.
- Use of the adapter in an unsuitable dishwasher (only suitable: M-iClean UM/UM+, UM M2 type, UM+ M2 type).

In addition, any misuse as described in the operating instructions of the associated dishwashing machine shall apply.

2.3 Safety information

- Only operate the bottle rack if it is in perfect working order.
- Washware must not come into contact with rotating parts of the dishwashing machine.
- Do not use damaged and incomplete bottle racks and adapters.
- Do not change the bottle rack and adapter.
- Only use commercially available, approved detergents for commercial dishwashers in the correct dosage.
- Empty the bottle rack completely before not using it for a longer period of time. To do so, place the bottle rack on the side of the connection openings until all the water has drained from the internal channels.
- Store the bottle rack in a clean, dry place away from sunlight and high temperatures.

2.4 Requirements for the personnel

For the bottle rack, the same requirements for personnel apply as for the dishwashing machine.

3 Product description

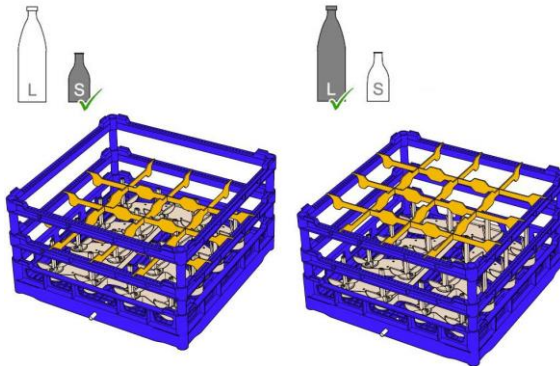

Up to 16 bottles can be rinsed in the bottle rack. The bottle rack consists of four parts: the base rack, the two-stage rack frame and a standard compartment division for bottles with diameters > 100 mm. Depending on the bottle size, the compartment partition can be inserted into the lower rack frame for smaller and medium bottles or into the upper rack frame for larger bottles.

A hygienic result in accordance with DIN 10511 (food hygiene - commercial glass washing with glasswasher) is achieved when the bottles are positioned vertically above the nozzles and the bottle programme, see page 8, has been selected.

Bottle centring device for bottles with diameter < 100 mm (optional)

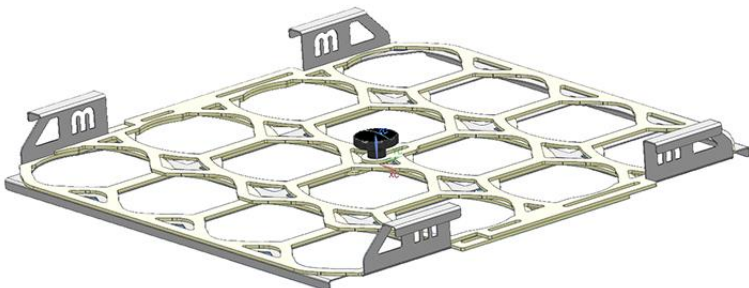

A separate bottle centring device is available to fix narrow bottles vertically above the nozzles. This is connected to the rack frame instead of the compartment division.

For operating the bottle rack, see page 9.

3.1 Bottle properties

Bottle dimensions

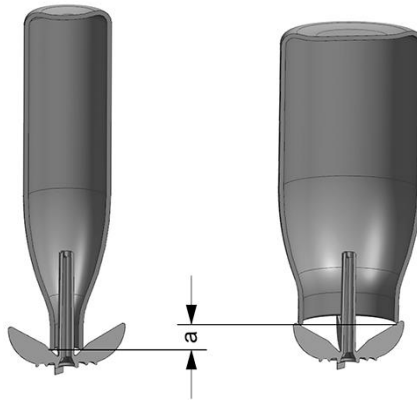

- a Bottles with a large outer diameter of the bottle neck stand up to 15 mm higher on the nozzles.

	M-iClean UM	M-iClean UM+
Max. bottle height (depending on the outer diameter of the bottle neck)	235–250 mm	355–370 mm
Bottle height min.	85 mm	
Max. outer diameter of bottle neck	80 mm	
Max. outer diameter of bottle	114 mm	
Min. inner diameter of bottle neck	18 mm	

Suitable bottle types (minimum weight per bottle = 30 g without cover grid):

Bottle contents	Restrictions
Water	None
Juice/lemonade	Max. drying time of 2 hours
Milk (not suitable for cleaning baby milk bottles)	
Beer/wine/sparkling wine	

3.2 Bottle programme



Note

Machines manufactured as of February 2021 are equipped with **bottle programme no. 25** as standard.

A separate programme has been developed for the bottle rack, which is made available on the machine by means of a firmware update. Contact MEIKO Service. This can also be done, for example, with regular maintenance.

Enter the wash programme in the quick selection bar



1. Press the MEIKO button for 3 s.

2. Enter **Code 10001**.



3. Open **i-menu**.

4. Select and confirm the **GLOBAL** item.

5. Select and confirm the **Parameter** item.

6. Select and confirm the desired **rinse programme location**.



7. Use **+ and -** to select **bottle programme no. 25**.

If bottle programme no. 25 is not available (a glass programme  is then displayed):

8. Select **cutlery programme no. 13** (for standard machines).



9. Select **cutlery programme no. 20** (for machines with A0 or Thermolabel process).

4 Operation/use

⚠ CAUTION – Danger of burns and scalding due to hot wash water, washware and machine parts

- Let the washware cool down before emptying.
- Let machine parts cool down or wear suitable gloves before changing the adapter (installation/removal).
- Do not open the door during the wash cycle.

The bottle rack is equipped with an adjustable bottle centring device. The bottle centring device must be adjusted during each wash cycle so that the bottles are positioned vertically and centrally above the respective nozzles in order not to negatively influence the cleaning result.

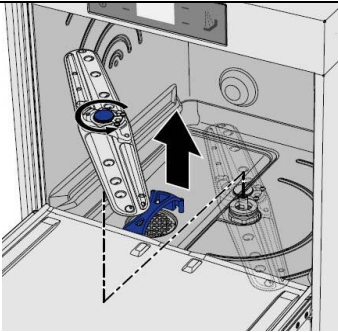

1. Remove lower wash arm.

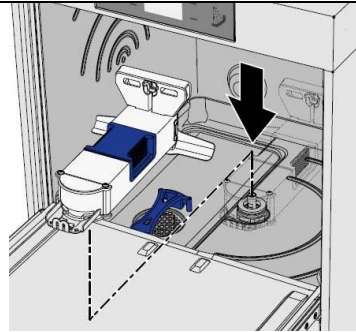

2. Place the adapter for the bottle rack on the wash arm hub.

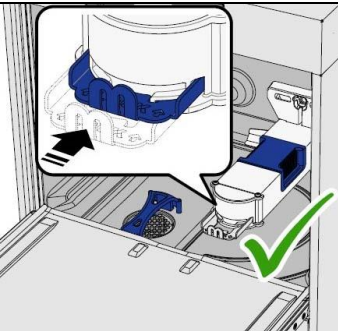

3. Lock adapter.

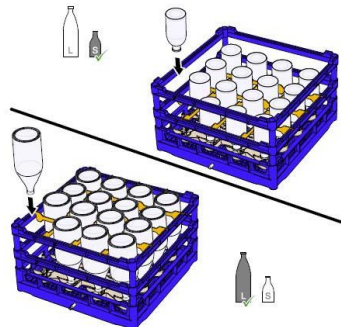

4. Fill the bottle rack. For small bottles, move the compartment division downwards.

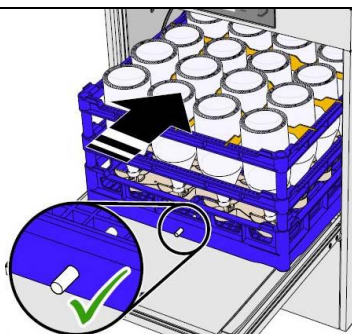

5. Slide the bottle rack into the dishwasher. The pin must be facing forward.

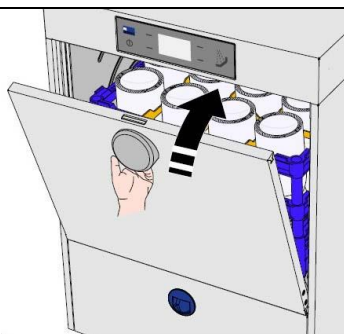

6. Close door.

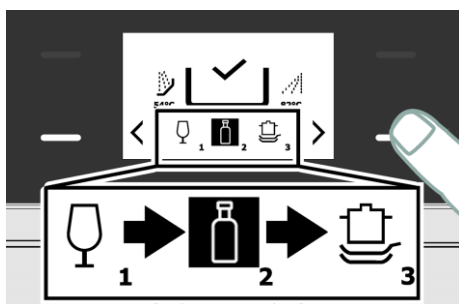

7. Select bottle programme.



8. Start programme.

5 Cleaning

To clean the bottle rack, it can be rinsed in the dishwashing machine without an adapter and with a built-in lower wash arm using any wash programme. Clean any clogged nozzles using a toothpick or similar object.

6 Index

B

Bottle properties 7

Bottle rinsing programme 8

C

Cleaning 10

D

Delivery contents 3

Designation of machine type 3

I

Intended use 4

M

Misuse 5

N

Notes on the operating instructions
..... 3

Notices on use 4

O

Operation/use 9

P

Presentation conventions 3

Product description 6

R

Related documents 3

Requirements for the personnel 5

S

Safety 4

Safety information 5

Safety symbols in the instructions. 4

.....
.....
.....
.....
.....
.....
.....
.....
.....
.....



MEIKO Maschinenbau GmbH & Co. KG

Englerstraße 3

77652 Offenburg

Germany

www.meiko-global.com

info@meiko-global.com

Design and construction subject to change without prior notice!