

Bottle rack

Operating manual

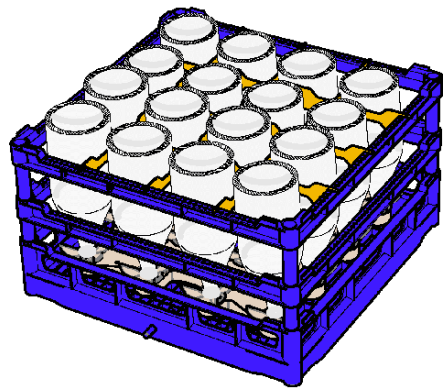

DE:

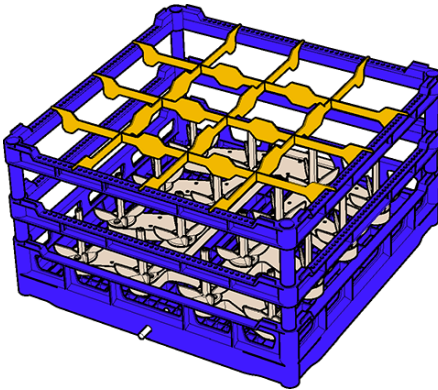

EN:



EN-US



Read the operating instructions before using the bottle rack!

Contents

- 1 NOTES ON THE OPERATING INSTRUCTIONS 3**
 - 1.1 Product identification 3
 - 1.2 Delivery contents 3
 - 1.3 Related documents 3
 - 1.4 Illustration 3
 - 1.4.1 *Safety symbols in the instructions* 4
- 2 SAFETY 4**
 - 2.1 Intended use 4
 - 2.2 Misuse 5
 - 2.3 Safety information 5
 - 2.4 Requirements for the personnel 5
- 3 PRODUCT DESCRIPTION 6**
 - 3.1 Bottle properties 7
 - 3.2 Bottle program 8
- 4 OPERATION/USE 9**
- 5 CLEANING 10**
- 6 INDEX 11**

1 Notes on the operating instructions

Before using the bottle rack, read the operating instructions and the related documents carefully and keep them in a safe place and within easy reach.

These operating instructions can be downloaded via the following address: www.meiko.info or <https://partnernet.meiko-global.com>.

1.1 Product identification

These operating instructions apply to the bottle rack compatible with MEIKO dishwashing machines M-iClean UM and UM+.

1.2 Delivery contents

The delivery contents include:

- 1x bottle rack, 1x adapter
- Documentation, for details see **Related documents**

1.3 Related documents

In addition to these operating instructions, there are other documents:

- Operating instructions for M-iClean U
- Short operating instructions (in the scope of delivery)

1.4 Illustration

Warnings

 **DANGER** – indicates an imminently hazardous situation which, if not avoided, will result in serious injury or death.

 **WARNING** – indicates a potentially hazardous situation which, if not avoided, could result in serious injury or death.

 **CAUTION** – indicates a possible hazardous situation which, if not avoided, could result in minor or moderate injury or damage to property.

Notices on use



Note – indicates useful and important information about the product or its use.

Notes on using the document:

- A bullet point (•) indicates a list.
- Numerals (1.) indicate several action steps that must be executed in the specified order.
- Position numbers in the text that refer to position numbers in figures are shown in parentheses:
(1) Position number 1 in the figure
- The text is always below the figure and refers to it until a new image follows.

1.4.1 Safety symbols in the instructions



Read the operating instructions

2 Safety

2.1 Intended use

The bottle rack is intended exclusively for commercial use and is used to wash bottles in hotels, food service and communal catering. Suitable bottle types, see page 7. The maximum or minimum bottle heights and diameters must not be exceeded or fallen short of. The cover grid (pt # 8510023) from the MEIKO rack range can be used for bottles or containers lighter than 30 g (1 oz).

The bottle rack is only suitable for M-iClean UM/UM+ type and dishwashing machines. For any use of the bottle rack for cleaning bottles, the supplied adapter must be inserted and locked in place of the lower rotating arm of the dishwashing machine, see page 9. The bottle rack may only be used with the wash programs approved for the bottle rack, see page 8.

2.2 Misuse

- Washing of bottles that are not suitable for cleaning in the bottle rack, see page 7.
- Use of an unsuitable wash program with too short a runtime, too low temperatures and too little rinse water volume.
- Use of the adapter in an unsuitable dishwasher (only suitable: M-iClean UM/UM+ type).

In addition, any misuse as described in the operating instructions of the associated dishwashing machine shall apply.

2.3 Safety information

- Only operate if the bottle rack is in perfect working order.
- Bottles must not come into contact with rotating parts of the dishwashing machine.
- Do not use damaged and incomplete bottle racks and adapters.
- Do not change the bottle rack and adapter.
- Only use commercially available, approved detergents for commercial dishwashers in the correct dosage.
- Empty the bottle rack completely if not using it for a long period of time. To do so, place the bottle rack on the side of the connection openings until all the water has drained from the internal channels.
- Store the bottle rack in a clean, dry place away from sunlight and high temperatures.

2.4 Requirements for the personnel

For the bottle rack, the same requirements for personnel apply as for the dishwashing machine.

3 Product description

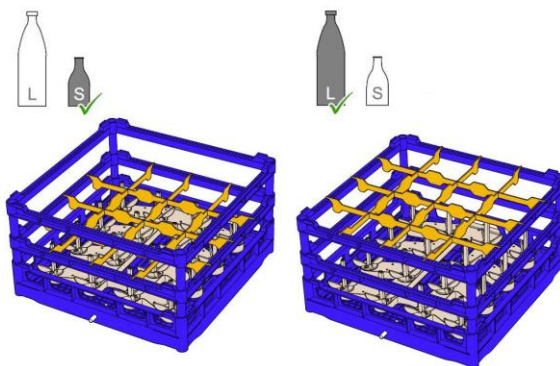

Up to 16 bottles can be rinsed in the bottle rack. The bottle rack consists of four parts: the base rack, the two-stage rack frame and a standard compartment divider for bottles with diameters > 100 mm (3.94 in). Depending on the bottle size, the compartment divider can be inserted into the lower rack frame for smaller and medium bottles or into the upper rack frame for larger bottles.

A hygienic result in accordance with DIN 10511 (food hygiene - commercial glass washing with glasswasher) is achieved when the bottles are positioned vertically above the nozzles and the bottle program, see page 8, has been selected.

Bottle centering device for bottles with diameter < 100 mm (3.94 in) (optional)

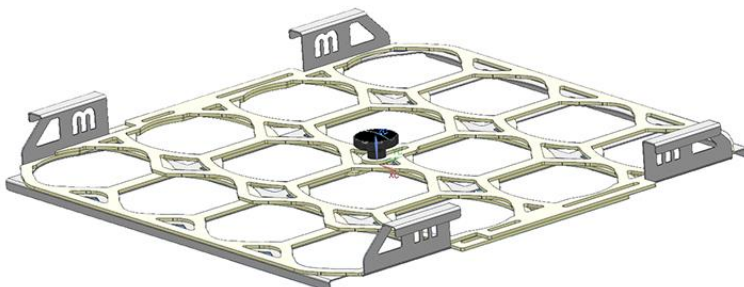

A separate bottle centering device (pt # 9785788) is available to fix narrow bottles vertically above the nozzles. This is connected to the rack frame instead of the compartment divider.

For operating the bottle rack, see page 9.

3.1 Bottle properties

Bottle dimensions

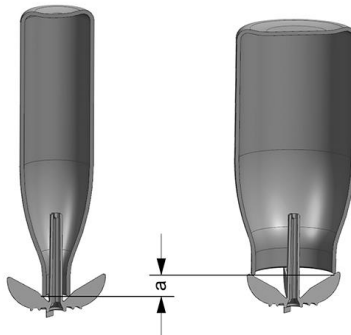

- a Bottles with a large outer diameter of the bottle neck stand up to 15 mm / 0.59 in higher on the nozzles.

	M-iClean UM	M-iClean UM+
Max. bottle height (depending on the outer diameter of the bottle neck)	235–250 mm 9.25–9.84 in	355–370 mm 13.97–14.57 in
Bottle height min.	85 mm / 3.35 in	
Max. outer diameter of bottle neck	80 mm / 3.15 in	
Max. outer diameter of bottle	114 mm / 4.49 in	
Min. inner diameter of bottle neck	18 mm / 0.71 in	

Suitable bottle types (minimum weight per bottle = 30 g / 1 oz without cover grid):

Bottle contents	Restrictions
Water	None
Juice/lemonade	Max. drying time of 2 hours
Milk (not suitable for cleaning baby milk bottles)	
Beer/wine/sparkling wine	

3.2 Bottle program



Note

Machines manufactured as of February 2021 are equipped with **bottle program no. 25** as standard.

A separate program has been developed for the bottle rack, which is made available on the machine by means of a firmware update. Contact MEIKO Service for assistance. This can also be done at the same time if you are having regularly scheduled maintenance performed.

Enter the wash program in the quick selection bar



1. Press the MEIKO button for 3 seconds.
2. Enter **Code 10001**.
3. Open **i-menu**.
4. Select and confirm the **GLOBAL** item.
5. Select and confirm the **Parameter** item.
6. Select and confirm the desired **wash program location**.



7. Use **+ and –** to select **bottle program no. 25**.

If bottle program no. 25 is not available (a glass program



is then displayed):



8. Select **cutlery program no. 13** (for standard machines).
9. Select **cutlery program no. 20** (for machines with A0 or Thermolabel process).

4 Operation/use

⚠ CAUTION – Danger of burns and scalding due to hot wash water, hot bottles and machine parts

- Let the bottles cool down before emptying.
- Let machine parts cool down or wear suitable gloves before changing the adapter (installation/removal).
- Do not open the door during the wash cycle.

The bottle rack is equipped with an adjustable bottle centering device. The bottle centering device must be adjusted during each wash cycle so that the bottles are positioned vertically and centrally above the respective nozzles in order not to negatively influence the cleaning result.

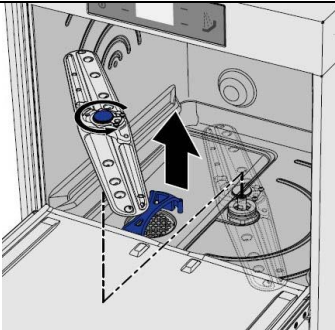

1. Remove lower wash arm.

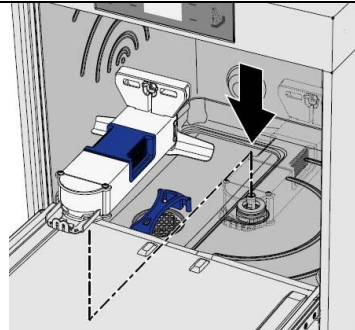

2. Place the adapter for the bottle rack on the wash arm hub.

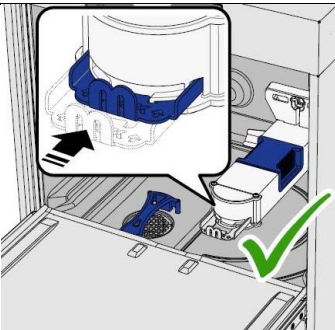

3. Lock adapter.

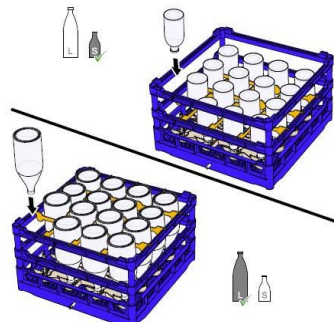

4. Fill the bottle rack. For small bottles, move the compartment divider downwards.

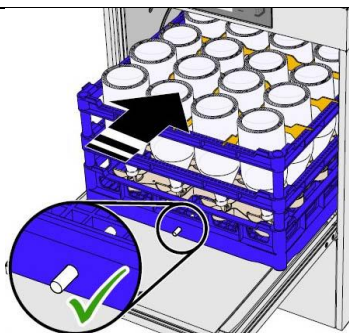

5. Slide the bottle rack into the dishwasher. The pin must be facing forward.

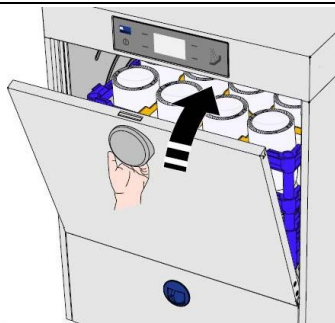

6. Close door.

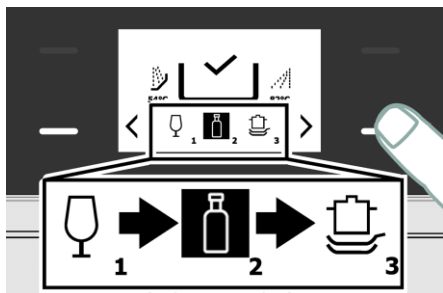

7. Select bottle program.



8. Start program.

5 Cleaning

To clean the bottle rack, it can be washed in the dishwashing machine without an adapter and with a built-in lower wash arm using any wash program. Clean any clogged nozzles using a toothpick or similar object.

6 Index

B

Bottle properties 7
Bottle wash program 8

C

Cleaning 10

D

Delivery contents 3
Designation 3

I

Illustration 3
Intended use 4

M

Misuse 5

N

Notes on the operating instructions 3
Notices on use 4

O

Operation/use 9

P

Product description 6

R

Related documents 3
Requirements for the personnel 5

S

Safety 4
Safety information 5
Safety symbols in the instructions. 4



Scan QR code to access MEIKO U.S. ASA listings.
ASA listing can also be accessed at
www.meiko.us



**MEIKO Maschinenbau
GmbH & Co. KG**

Englerstraße 3
77652 Offenburg
Germany
www.meiko-global.com
info@meiko-global.com

MEIKO USA, Inc.

1349 Heil Quaker Boulevard La
Vergne, TN 37086
Phone (615) 399-6600
Toll Free (800) 55 MEIKO
Fax (615) 399-6620
sales@meiko.us
24H Toll Free Service +1 800 868
3840
service@meiko.us